

Country Camping RV

3101 10 Ave SW, Salmon Arm, BC, V1E 3K1

1 (888) 418-1313

2022 FOREST RIVER FLAGSTAFF E-PRO 16BH

Type:	RV (Travel Trailer)
Colour:	WHITE
Interior:	GREY
Sleeps:	5
LxWxH (ft):	18 x 7 x 9
Weight (lbs):	2,993 (GVWR: 3,800)
Tank (gallons):	31 (fresh), 30 (gray), 30 (black)
Stock #:	21N2029

See dealer for pricing details

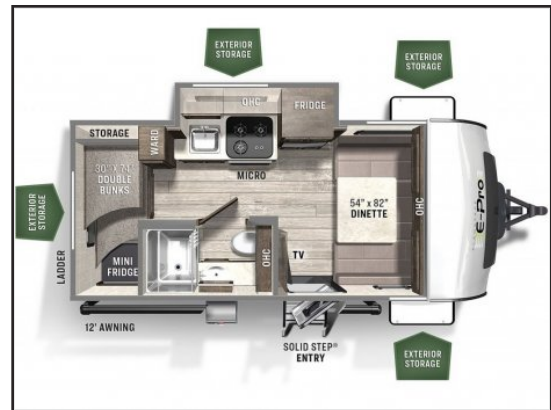

FEATURES

- 100 Watt Roof Mount Solar Panel W/ 1000 Watt Inverter
- 2- 20# LP Bottles
- AM/FM Stereo W/ Bluetooth And USB
- Air Conditioning
- Bunk Beds
- Co2 Detector
- Electric Tongue
- Exterior Shower
- FRAMELESS WINDOWS
- Lpg Detector
- Microwave
- Outside Griddle With LP Hook Up
- Polished Alloy Wheels
- Power Awning (N/A 12SRK)
- Quick Recovery Gas/Electric Water Heater
- Shower
- Smoke Detector
- **And more!**
- 1000 WATT INVERTER
- 12 Volt TV W/ DVD Player
- 20,000 BTU Furnace
- AUTU IGNITE GAS/ELE WATER HEATER
- Awning
- CSA
- DEXTER TORSION AXLES
- Exterior Entertainment Center
- Fire Extinguisher
- MAX AIR VENT
- Multidirectional TV Antenna
- Outside Kitchen
- Outside Speaker (N/A 12SRK)
- Power Tongue Jack
- Refrigerator
- Roller Shades
- Skylight
- Spare Tire

COMMENTS: Flagstaff E-Pro Travel Trailers

We have custom designed our trailers with the best in style and amenities while keeping your towing needs in mind. The Flagstaff E-Pro line of trailers are for those campers that have chosen to drive todays more fuel efficient and smaller SUVs. With floor plan weights within these vehicles towing capability, E-Pro is an exciting way to go camping using the vehicle you drive every day.

E-Pro is now offering more standards and options than anyone in its class. Standard on most models include a AM/FM stereo with Bluetooth and a USB port, a 12Volt TV with a built in DVD Player, a rear ladder, a WIFI Ranger booster with available WIFI connectivity, a roof mount solar panel with a 1000 Watt converter, a Shower Miser Water Saver, plus many more standard features. Options include a 13,500 BTU AC, a tongue mount bike rack, an off road package that includes a lift kit and 15 Mud...

Prices are plus taxes, license, and a documentation fee.
Confirm all details and specifications with the dealer.

3101 10 Ave SW
Salmon Arm, BC, V1E 3K1

www.countrycampingrv.com
1 (888) 418-1313

